



GEORGE STOWE ARCHITECT
 member, American Institute of Architects
 184 East Chestnut Street • Asheville, NC 28801
 ph 828-251-2357 • fax 828-225-0530
 gstowearchitect@bellsouth.net
 www.GeorgeStoweArchitect.com

DATE:
02-10-2017
 REVISIONS:

ADOPT a PLOT for
Beaver Lake Bird Sanctuary
 PHASE 1 of a 2 PHASE PROJECT
 1056 Merimon Avenue, Asheville, NC

A1

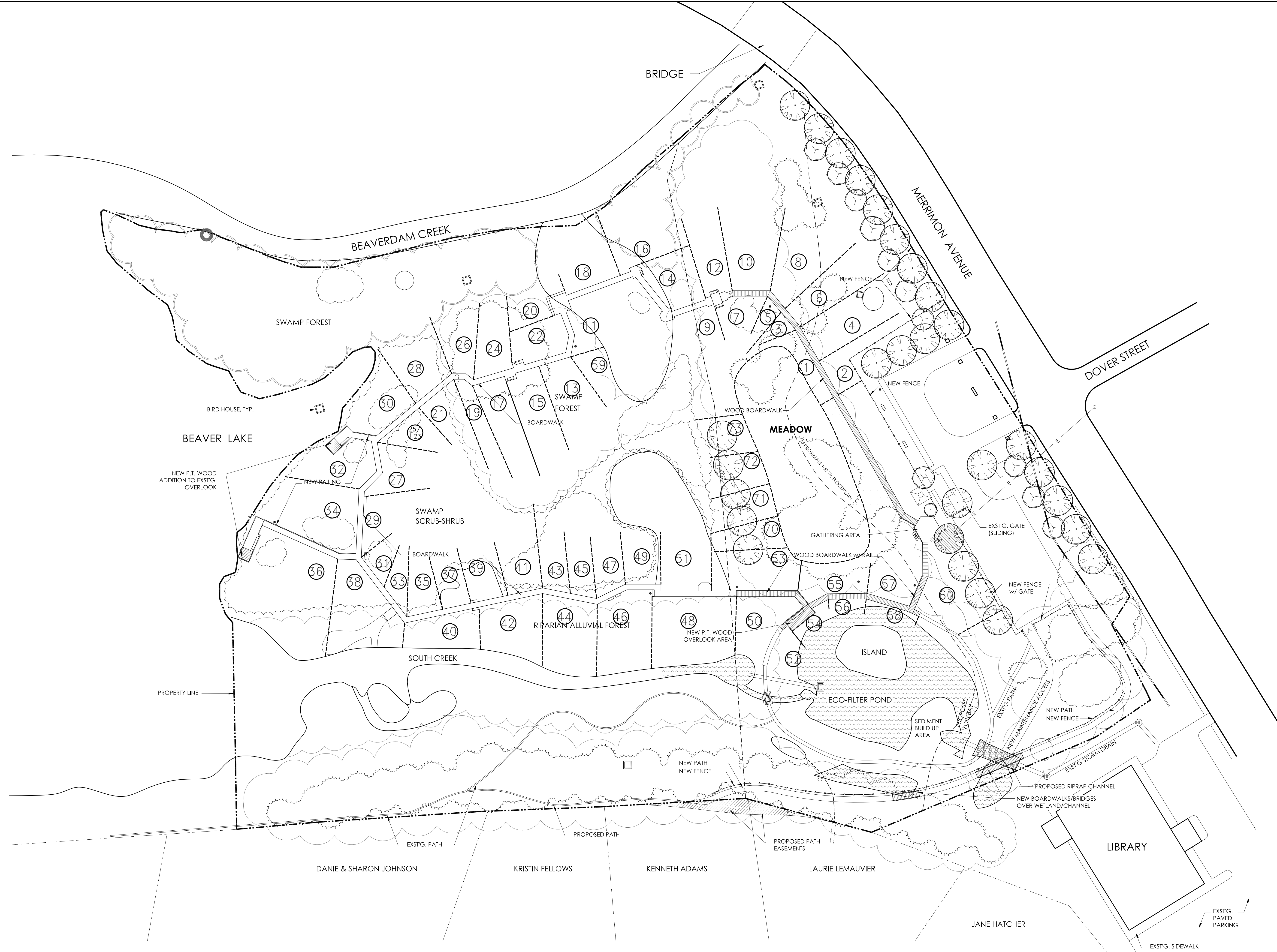

1 Adopt a Plot Site Plan
 A1 Scale: 1" = 40'-0"